

# Agenda

www.oxford.gov.uk



## Licensing & Gambling Acts Casework Sub-Committee

Date: **Monday 16 October 2017**

---

Time: **5.30 pm**

---

Place: **Council Chamber, Town Hall**

---

For any further information please contact:

**John Mitchell, Committee and Member Services Officer**

Telephone: 01865252217

Email: [jmitchell@oxford.gov.uk](mailto:jmitchell@oxford.gov.uk)

---

### Membership

Councillor James Fry

Councillor Ruthi Brandt

Councillor Dan Iley-Williamson

## AGENDA

	<b>Pages</b>
<b>1 KuPP Rooftop Restaurant At John Lewis</b>	3 - 34
Application for a new premises licence: KuPP Rooftop Restaurant At John Lewis, The Westgate, Oxford, OX1 1PB.	
Report attached.	

**To:** Licensing and Gambling Acts Sub-Committee  
**Date:** 16<sup>th</sup> October 2017  
**Report of:** Head of Community Services  
**Title of Report:** Faucet Inn Limited - Application for a New Premises Licence: KuPP Rooftop Restaurant At John Lewis, The Westgate, Oxford, OX1 1PB  
**Application Ref:** 17/03575/PREM

<b>Summary and recommendations</b>	
<b>Purpose of report:</b>	To inform the determination of the Faucet Inn Limited application for a New Premises Licence for the KuPP Rooftop Restaurant At John Lewis, The Westgate, Oxford, OX1 1PB
<b>Corporate Priority:</b>	A vibrant and sustainable economy
<b>Recommendation(s):</b>	That the Licensing and Gambling Acts Sub-Committee resolves to:
	1. determine the Faucet Inn Limited's application taking into account the details in this report and any representations made at this Sub-Committee meeting.

<b>Appendices</b>	
Appendix 1	Application for a New Premises Licence
Appendix 2	Representation from Interested Party
Appendix 3	Location Map

## **Introduction and background**

1. This report is made to the Licensing & Gambling Acts Casework Sub- Committee so it may determine in accordance with its powers and the Licensing Act 2003 whether to grant a Premises Licence to Faucet Inn Limited.

## Application Summary

- An application for a New Premises Licence has been submitted by Faucet Inn Limited. A summary of the licensable activities applied for and the time proposed for these activities can be found detailed below:

### Supply of Alcohol (On and Off Sales), Films, Live Music, Recorded Music, Performance of Dance, Similar Entertainment to Music or Dance (Indoors Only):

Monday to Thursday	08:00 hours until 00:30 hours
Friday to Saturday	08:00 hours until 01:00 hours
Sunday	08:00 hours until 00:30 hours
New Year's Eve	08:00 hours until 01:00 hours

### Late Night Refreshment (Indoors and outdoors):

Monday to Thursday	23:00 hours until 01:00 hours
Friday to Saturday	23:00 hours until 01:30 hours
Sunday to Saturday	23:00 hours until 01:00 hours
New Year's Eve	23:00 hours until 01:30 hours

- Both the application and the steps that the applicant intends to take to promote the licensing objectives (as set out in the operating schedule) can be found at **Appendix One**.

## Relevant Representations

- No representations have been received from the Responsible Authorities.

Responsible Authority	Response	Licensing Objective(s)
Thames Valley Police	No Representation	
Fire and Rescue Service	No Representation	
Environmental Health	No Representation	
Health and Safety	No Representation	
Planning	No Representation	
Trading Standards	No Representation	
Child Safeguarding	No Representation	
Licensing Authority	No Representation	

- Valid representations have been received from an Interested Party as detailed in the table below. A copy of this representation is attached at **Appendix Two**.

Name	Address	Licensing Objective(s)
Mr J B Barnard	8 Thames Street, Oxford	Crime and Disorder, Public Nuisance

## Location

6. A map is attached at **Appendix Three** showing the general location of the applicant's premises, and the proximity to the premises of those who have raised objections to the application.

## Statement of Licensing Policy

7. The Sub-Committee is referred to the Council's Statement of Licensing Policy. In particular, the following paragraphs have a bearing upon the application:

Relevant Policy Matters	Section	Policy
<b>Crime &amp; Disorder:</b>	8.5.1 to 8.5.3	OS9
<b>Public Nuisance:</b>	7.3.1 to 7.3.6	LA3 to LA5
	7.3.8	
	7.3.10	
	7.5.1 to 7.5.2	

8. A copy of the Statement of Licensing Policy may be obtained from the Council Offices or found online at:  
[https://www.oxford.gov.uk/downloads/file/1303/statement\\_of\\_licensing\\_policy](https://www.oxford.gov.uk/downloads/file/1303/statement_of_licensing_policy)

## Home Office Statutory Guidance

9. Members are also referred to the statutory guidance issued by the Home Office. Of particular relevance to this application are the following matters:

Relevant Sections	Relevant Paragraph
<b>Crime &amp; Disorder:</b>	2.1 to 2.5
<b>Public Nuisance:</b>	2.14 to 2.20

10. A copy of the Home Office Statutory Guidance may be found online at:  
**[www.gov.uk/government/publications/revised-guidance-issued-under-section-182-of-the-licensing-act-2003](http://www.gov.uk/government/publications/revised-guidance-issued-under-section-182-of-the-licensing-act-2003)**

## Other Relevant Considerations

11. The Sub-Committee is reminded of its responsibilities under the Crime and Disorder Act 1998 (to co-operate in the reduction of crime and disorder in Oxford) and the Human Rights Act (which guarantees the right to a fair hearing for all parties in the determination of their civil rights, and also provides for the protection of property, which may include licences in existence, and the protection of private and family life) when considering the fair balance between the interests of the

applicant and the rights of local residents. Any decision taken by the Sub-Committee must be necessary and proportionate to the objectives being pursued.

12. Members are reminded that whenever they make a decision under the Licensing Act 2003, they have a duty to act with a view to promoting the licensing objectives.
13. When considering any representations, only those issues relating to the four licensing objectives should be considered and appropriate weight given to the importance and relevance of each representation.
14. In making its decision, Members must also have regard to the Home Office statutory guidance issued under section 182 of the Licensing Act 2003 and the Council's own Statement of Licensing Policy.
15. The Sub-Committee must take such of the following steps as it considers appropriate for the promotion of the licensing objectives:
  - a) **Grant the licence in accordance with the application.**
  - b) **Modify the conditions of the operating schedule by altering or omitting or adding to them.**
  - c) **Exclude or restrict from the scope of the licence any of the licensable activities to which the application relates.**
  - d) **Reject the whole of the application.**

The Sub-Committee may also grant the licence subject to different conditions for different parts of the premises or the different licensable activities.

16. Members are asked to note that they may not modify the conditions or reject whole or part of the application merely because they consider it desirable to do so. It must be appropriate to do so in order to promote the licensing objectives. Any such step must relate to a relevant representation made.
17. If Members grant the application, the details of the operating schedule will be incorporated into the licence as conditions. The licence will also be subject to certain mandatory conditions.
18. Members should note that the applicant or persons making representations have the right of appeal against the decision made by the Sub-Committee.

<b>Report author</b>	Allan P. Hibberd
Job title	Licensing Officer
Service area or department	Community Services
Telephone	01865 252565
e-mail	<a href="mailto:licensing@oxford.gov.uk">licensing@oxford.gov.uk</a>



This page is intentionally left blank





**Oxford**  
**Application for a premises licence**  
**Licensing Act 2003**

For help contact  
elms@oxford.gov.uk  
Telephone: 01865 252565

\* required information

**Section 1 of 21**

You can save the form at any time and resume it later. You do not need to be logged in when you resume.

System reference  This is the unique reference for this application generated by the system.

Your reference  You can put what you want here to help you track applications if you make lots of them. It is passed to the authority.

Are you an agent acting on behalf of the applicant?

Yes  No

Put "no" if you are applying on your own behalf or on behalf of a business you own or work for.

The Licensing Authority  
Oxford City Council

29 AUG 2017

**Applicant Details**

\* First name

\* Family name

\* E-mail

Main telephone number  Include country code.

Other telephone number

Indicate here if the applicant would prefer not to be contacted by telephone

Is the applicant:

Applying as a business or organisation, including as a sole trader  
 Applying as an individual

A sole trader is a business owned by one person without any special legal structure. Applying as an individual means the applicant is applying so the applicant can be employed, or for some other personal reason, such as following a hobby.

**Applicant Business**

Is the applicant's business registered in the UK with Companies House?  Yes  No

Note: completing the Applicant Business section is optional in this form.

Registration number

Business name  If the applicant's business is registered, use its registered name.

VAT number

Put "none" if the applicant is not registered for VAT.

Legal status

Continued from previous page...

Applicant's position in the business

Home country

The country where the applicant's headquarters are.

**Registered Address**

Address registered with Companies House.

Building number or name

Street

District

City or town

County or administrative area

Postcode

Country

**Agent Details**

\* First name

\* Family name

\* E-mail

Main telephone number

Include country code.

Other telephone number

Indicate here if you would prefer not to be contacted by telephone

Are you:

An agent that is a business or organisation, including a sole trader

A sole trader is a business owned by one person without any special legal structure.

A private individual acting as an agent

**Agent Business**

Is your business registered in the UK with Companies House?  Yes  No

Note: completing the Applicant Business section is optional in this form.

Registration number

Business name

If your business is registered, use its registered name.

VAT number

Put "none" if you are not registered for VAT.

Legal status

*Continued from previous page...*

Your position in the business

Home country

The country where the headquarters of your business is located.

**Agent Registered Address**

Address registered with Companies House.

Building number or name

Street

District

City or town

County or administrative area

Postcode

Country

**Section 2 of 21**

**PREMISES DETAILS**

I/we, as named in section 1, apply for a premises licence under section 17 of the Licensing Act 2003 for the premises described in section 2 below (the premises) and I/we are making this application to you as the relevant licensing authority in accordance with section 12 of the Licensing Act 2003.

**Premises Address**

Are you able to provide a postal address, OS map reference or description of the premises?

Address     OS map reference     Description

**Postal Address Of Premises**

Building number or name

Street

District

City or town

County or administrative area

Postcode

Country

**Further Details**

Telephone number

Non-domestic rateable value of premises (£)

**Section 3 of 21****APPLICATION DETAILS**

In what capacity are you applying for the premises licence?

- An individual or individuals
- A limited company / limited liability partnership
- A partnership (other than limited liability)
- An unincorporated association
- Other (for example a statutory corporation)
- A recognised club
- A charity
- The proprietor of an educational establishment
- A health service body
- A person who is registered under part 2 of the Care Standards Act 2000 (c14) in respect of an independent hospital in Wales
- A person who is registered under Chapter 2 of Part 1 of the Health and Social Care Act 2008 in respect of the carrying on of a regulated activity (within the meaning of that Part) in an independent hospital in England
- The chief officer of police of a police force in England and Wales

**Confirm The Following**

- I am carrying on or proposing to carry on a business which involves the use of the premises for licensable activities
- I am making the application pursuant to a statutory function
- I am making the application pursuant to a function discharged by virtue of Her Majesty's prerogative

**Section 4 of 21****NON INDIVIDUAL APPLICANTS**

Provide name and registered address of applicant in full. Where appropriate give any registered number. In the case of a partnership or other joint venture (other than a body corporate), give the name and address of each party concerned.

**Non Individual Applicant's Name**

Name

**Details**

Registered number (where applicable)

Description of applicant (for example partnership, company, unincorporated association etc)

Continued from previous page...

Limited

**Address**

Building number or name

Street

District

City or town

County or administrative area

Postcode

Country

**Contact Details**

E-mail

Telephone number

Other telephone number

\* Date of birth  /  /   
dd mm yyyy

\* Nationality  Documents that demonstrate entitlement to work in the UK

**Section 5 of 21**

**OPERATING SCHEDULE**

When do you want the premises licence to start?  /  /   
dd mm yyyy

If you wish the licence to be valid only for a limited period, when do you want it to end  /  /   
dd mm yyyy

Provide a general description of the premises

For example the type of premises, its general situation and layout and any other information which could be relevant to the licensing objectives. Where your application includes off-supplies of alcohol and you intend to provide a place for consumption of these off-supplies you must include a description of where the place will be and its proximity to the premises.

John Lewis Department store over various floors with "off" sales throughout the retail areas and "on" sales in: the cafe on the ground floor (with external seating area); The Place to Eat (First Floor); the Partners Dining room (Basement) for Partners and their bona fide guests only and the restaurant on the roof (with external seating area and with separate access at times the Store is closed) in force for John Lewis PLC.

Continued from previous page...

This application relates to the restaurant on the roof level which will be operated by the applicant. John Lewis will therefore have a "shadow licence" for that restaurant during the applicants occupation of that space.

If 5,000 or more people are expected to attend the premises at any one time, state the number expected to attend

**Section 6 of 21**

**PROVISION OF PLAYS**

See guidance on regulated entertainment

Will you be providing plays?

- Yes  No

**Section 7 of 21**

**PROVISION OF FILMS**

See guidance on regulated entertainment

Will you be providing films?

- Yes  No

**Standard Days And Timings**

MONDAY

Start

End

Start

End

TUESDAY

Start

End

Start

End

WEDNESDAY

Start

End

Start

End

THURSDAY

Start

End

Start

End

FRIDAY

Start

End

Start

End

SATURDAY

Start

End

Start

End

Give timings in 24 hour clock. (e.g., 16:00) and only give details for the days of the week when you intend the premises to be used for the activity.

Continued from previous page...

SUNDAY

Start

End

Start

End

Will the exhibition of films take place indoors or outdoors or both?

- Indoors       Outdoors       Both

Where taking place in a building or other structure tick as appropriate. Indoors may include a tent.

State type of activity to be authorised, if not already stated, and give relevant further details, for example (but not exclusively) whether or not music will be amplified or unamplified.

State any seasonal variations for the exhibition of film

For example (but not exclusively) where the activity will occur on additional days during the summer months.

Non standard timings. Where the premises will be used for the exhibition of film at different times from those listed in the column on the left, list below

For example (but not exclusively), where you wish the activity to go on longer on a particular day e.g. Christmas Eve.

New Years Eve 0800 until 0100

**Section 8 of 21**

**PROVISION OF INDOOR SPORTING EVENTS**

See guidance on regulated entertainment

Will you be providing indoor sporting events?

- Yes       No

**Section 9 of 21**

**PROVISION OF BOXING OR WRESTLING ENTERTAINMENTS**

See guidance on regulated entertainment

Will you be providing boxing or wrestling entertainments?

- Yes       No

**Section 10 of 21**

**PROVISION OF LIVE MUSIC**

See guidance on regulated entertainment

Will you be providing live music?

Continued from previous page...

**Standard Days And Timings**

MONDAY

Start

End

Start

End

Give timings in 24 hour clock.  
(e.g., 16:00) and only give details for the days  
of the week when you intend the premises  
to be used for the activity.

TUESDAY

Start

End

Start

End

WEDNESDAY

Start

End

Start

End

THURSDAY

Start

End

Start

End

FRIDAY

Start

End

Start

End

SATURDAY

Start

End

Start

End

SUNDAY

Start

End

Start

End

Will the performance of live music take place indoors or outdoors or both?

- Indoors       Outdoors       Both

Where taking place in a building or other  
structure tick as appropriate. Indoors may  
include a tent.

State type of activity to be authorised, if not already stated, and give relevant further details, for example (but not exclusively) whether or not music will be amplified or unamplified.

State any seasonal variations for the performance of live music

For example (but not exclusively) where the activity will occur on additional days during the summer months.



Continued from previous page...

Non-standard timings. Where the premises will be used for the performance of live music at different times from those listed in the column on the left, list below

For example (but not exclusively), where you wish the activity to go on longer on a particular day e.g. Christmas Eve.

New Years Eve 0800 until 0100

**Section 11 of 21**

**PROVISION OF RECORDED MUSIC**

See guidance on regulated entertainment

Will you be providing recorded music?

Yes                       No

**Standard Days And Timings**

MONDAY

Start   
Start

End   
End

Give timings in 24 hour clock.  
(e.g., 16:00) and only give details for the days  
of the week when you intend the premises  
to be used for the activity.

TUESDAY

Start   
Start

End   
End

WEDNESDAY

Start   
Start

End   
End

THURSDAY

Start   
Start

End   
End

FRIDAY

Start   
Start

End   
End

SATURDAY

Start   
Start

End   
End

Continued from previous page...

SUNDAY

Start 08:00

End 00:30

Start

End

Will the playing of recorded music take place indoors or outdoors or both?

- Indoors
- Outdoors
- Both

Where taking place in a building or other structure tick as appropriate. Indoors may include a tent.

State type of activity to be authorised, if not already stated, and give relevant further details, for example (but not exclusively) whether or not music will be amplified or unamplified.

[Empty box for activity details]

State any seasonal variations for playing recorded music

For example (but not exclusively) where the activity will occur on additional days during the summer months.

[Empty box for seasonal variations]

Non-standard timings. Where the premises will be used for the playing of recorded music at different times from those listed in the column on the left, list below

For example (but not exclusively), where you wish the activity to go on longer on a particular day e.g. Christmas Eve.

New Years Eve 0800 until 0100

**Section 12 of 21**

**PROVISION OF PERFORMANCES OF DANCE**

See guidance on regulated entertainment

Will you be providing performances of dance?

- Yes
- No

**Standard Days And Timings**

MONDAY

Start 08:00

End 00:30

Start

End

Give timings in 24 hour clock. (e.g., 16:00) and only give details for the days of the week when you intend the premises to be used for the activity.

TUESDAY

Start 08:00

End 00:30

Start

End

Continued from previous page...

WEDNESDAY

Start	<input type="text" value="08:00"/>	End	<input type="text" value="00:30"/>
Start	<input type="text"/>	End	<input type="text"/>

THURSDAY

Start	<input type="text" value="08:00"/>	End	<input type="text" value="00:30"/>
Start	<input type="text"/>	End	<input type="text"/>

FRIDAY

Start	<input type="text" value="08:00"/>	End	<input type="text" value="01:00"/>
Start	<input type="text"/>	End	<input type="text"/>

SATURDAY

Start	<input type="text" value="08:00"/>	End	<input type="text" value="01:00"/>
Start	<input type="text"/>	End	<input type="text"/>

SUNDAY

Start	<input type="text" value="08:00"/>	End	<input type="text" value="00:30"/>
Start	<input type="text"/>	End	<input type="text"/>

Will the performance of dance take place indoors or outdoors or both?

- Indoors       Outdoors       Both

Where taking place in a building or other structure tick as appropriate. Indoors may include a tent.

State type of activity to be authorised, if not already stated, and give relevant further details, for example (but not exclusively) whether or not music will be amplified or unamplified.

State any seasonal variations for the performance of dance

For example (but not exclusively) where the activity will occur on additional days during the summer months.

Non-standard timings. Where the premises will be used for the performance of dance at different times from those listed in the column on the left, list below

For example (but not exclusively), where you wish the activity to go on longer on a particular day e.g. Christmas Eve.

New Years Eve 0800 until 0100

Continued from previous page...

**Section 13 of 21**

**PROVISION OF ANYTHING OF A SIMILAR DESCRIPTION TO LIVE MUSIC, RECORDED MUSIC OR PERFORMANCES OF DANCE**

See guidance on regulated entertainment

Will you be providing anything similar to live music, recorded music or performances of dance?

Yes  No

**Section 14 of 21**

**LATE NIGHT REFRESHMENT**

Will you be providing late night refreshment?

Yes  No

**Standard Days And Timings**

MONDAY

Start

End

Start

End

Give timings in 24 hour clock. (e.g., 16:00) and only give details for the days of the week when you intend the premises to be used for the activity.

TUESDAY

Start

End

Start

End

WEDNESDAY

Start

End

Start

End

THURSDAY

Start

End

Start

End

FRIDAY

Start

End

Start

End

SATURDAY

Start

End

Start

End

SUNDAY

Start

End

Start

End

Continued from previous page...

Will the provision of late night refreshment take place indoors or outdoors or both?

- Indoors                       Outdoors                       Both

Where taking place in a building or other structure tick as appropriate. Indoors may include a tent.

State type of activity to be authorised, if not already stated, and give relevant further details, for example (but not exclusively) whether or not music will be amplified or unamplified.

State any seasonal variations

For example (but not exclusively) where the activity will occur on additional days during the summer months.

Non-standard timings. Where the premises will be used for the supply of late night refreshments at different times from those listed in the column on the left, list below

For example (but not exclusively), where you wish the activity to go on longer on a particular day e.g. Christmas Eve.

New Year's Eve until 0130

**Section 15 of 21**

**SUPPLY OF ALCOHOL**

Will you be selling or supplying alcohol?

- Yes                       No

**Standard Days And Timings**

MONDAY

Start

End

Start

End

TUESDAY

Start

End

Start

End

Give timings in 24 hour clock. (e.g., 16:00) and only give details for the days of the week when you intend the premises to be used for the activity.

Continued from previous page...

WEDNESDAY

Start 08:00

End 00:30

Start

End

THURSDAY

Start 08:00

End 00:30

Start

End

FRIDAY

Start 08:00

End 01:00

Start

End

SATURDAY

Start 08:00

End 01:00

Start

End

SUNDAY

Start 08:00

End 00:30

Start

End

Will the sale of alcohol be for consumption:

- On the premises     Off the premises     Both

If the sale of alcohol is for consumption on the premises select on, if the sale of alcohol is for consumption away from the premises select off. If the sale of alcohol is for consumption on the premises and away from the premises select both.

State any seasonal variations

For example (but not exclusively) where the activity will occur on additional days during the summer months.

Non-standard timings. Where the premises will be used for the supply of alcohol at different times from those listed in the column on the left, list below

For example (but not exclusively), where you wish the activity to go on longer on a particular day e.g. Christmas Eve.

New Years Eve 0800 until 0100

State the name and details of the individual whom you wish to specify on the licence as premises supervisor

Continued from previous page...

**Name**

First name

Family name

Date of birth  /  /   
dd mm yyyy

**Enter the contact's address**

Building number or name

Street

District

City or town

County or administrative area

Postcode

Country

Personal Licence number (if known)

Issuing licensing authority (if known)

**PROPOSED DESIGNATED PREMISES SUPERVISOR CONSENT**

How will the consent form of the proposed designated premises supervisor be supplied to the authority?

- Electronically, by the proposed designated premises supervisor
- As an attachment to this application

Reference number for consent form (if known)

If the consent form is already submitted, ask the proposed designated premises supervisor for its 'system reference' or 'your reference'.

**Section 16 of 21**

**ADULT ENTERTAINMENT**

Highlight any adult entertainment or services, activities, or other entertainment or matters ancillary to the use of the premises that may give rise to concern in respect of children

Give information about anything intended to occur at the premises or ancillary to the use of the premises which may give rise to concern in respect of children, regardless of whether you intend children to have access to the premises, for example (but not exclusively) nudity or semi-nudity, films for restricted age groups etc gambling machines etc.

Continued from previous page...

**Section 17 of 21**

**HOURS PREMISES ARE OPEN TO THE PUBLIC**

**Standard Days And Timings**

MONDAY

Start

End

Start

End

Give timings in 24 hour clock.  
(e.g., 16:00) and only give details for the days  
of the week when you intend the premises  
to be used for the activity.

TUESDAY

Start

End

Start

End

WEDNESDAY

Start

End

Start

End

THURSDAY

Start

End

Start

End

FRIDAY

Start

End

Start

End

SATURDAY

Start

End

Start

End

SUNDAY

Start

End

Start

End

State any seasonal variations

For example (but not exclusively) where the activity will occur on additional days during the summer months.

Non standard timings. Where you intend to use the premises to be open to the members and guests at different times from those listed in the column on the left, list below

For example (but not exclusively), where you wish the activity to go on longer on a particular day e.g. Christmas Eve.

New Years Eve to 01:30



Continued from previous page...

**Section 18 of 21**

**LICENSING OBJECTIVES**

Describe the steps you intend to take to promote the four licensing objectives:

a) General – all four licensing objectives (b,c,d,e)

List here steps you will take to promote all four licensing objectives together.

The application should be granted as an exception to the Local Authority's policy given the nature and character of the premises within the significant retail shopping development at the Westgate. John Lewis were granted a premises licence for the roof top restaurant for the same hours and activities set out in this application and the steps below are those which have been endorsed on that licence as conditions. KuPP is a scandinavian influenced restaurant where the emphasis is on food.

A Challenge 21 or 25 proof of age scheme shall be operated at the premises where the only acceptable forms of identification are recognised photographic identification cards, such as a driving licence passport or proof of age card with the PASS hologram.

All members of staff will be trained in the relation to the laws relating to the sale of alcohol and records of their training will be kept for a minimum period of 12 months and will be available for inspection by the police or Local Authority.

A record will be kept of any sale of alcohol which is refused.

b) The prevention of crime and disorder

CCTV will be provided in the premises and capable of recording and storing images for a minimum of 31 days.

c) Public safety

No additional steps identified above those duties required by other statutes

d) The prevention of public nuisance

No additional steps identified above those duties required by other statutes

e) The protection of children from harm

As above no additional steps identified

Continued from previous page...

## Section 19 of 21

### NOTES ON DEMONSTRATING ENTITLEMENT TO WORK IN THE UK

#### Entitlement to work/immigration status for individual applicants and applications from partnerships which are not limited liability partnerships:

A licence may not be held by an individual or an individual in a partnership who is resident in the UK who:

- does not have the right to live and work in the UK; or
- is subject to a condition preventing him or her from doing work relating to the carrying on of a licensable activity.

Any premises licence issued in respect of an application made on or after 6 April 2017 will become invalid if the holder ceases to be entitled to work in the UK.

Applicants must demonstrate that they have an entitlement to work in the UK and are not subject to a condition preventing them from doing work relating to the carrying on of a licensable activity. They do this by providing with this application copies or scanned copies of the following documents (which do not need to be certified).

#### Documents which demonstrate entitlement to work in the UK

- An expired or current passport showing the holder, or a person named in the passport as the child of the holder, is a British citizen or a citizen of the UK and Colonies having the right of abode in the UK [please see note below about which sections of the passport to copy].
- An expired or current passport or national identity card showing the holder, or a person named in the passport as the child of the holder, is a national of a European Economic Area country or Switzerland.
- A Registration Certificate or document certifying permanent residence issued by the Home Office to a national of a European Economic Area country or Switzerland.
- A Permanent Residence Card issued by the Home Office to the family member of a national of a European Economic Area country or Switzerland.
- A **current** Biometric Immigration Document (Biometric Residence Permit) issued by the Home Office to the holder indicating that the person named is allowed to stay indefinitely in the UK, or has no time limit on their stay in the UK.
- A **current** passport endorsed to show that the holder is exempt from immigration control, is allowed to stay indefinitely in the UK, has the right of abode in the UK, or has no time limit on their stay in the UK.
- A **current** Immigration Status Document issued by the Home Office to the holder with an endorsement indicating that the named person is allowed to stay indefinitely in the UK or has no time limit on their stay in the UK, **when produced in combination with** an official document giving the person's permanent National Insurance number and their name issued by a Government agency or a previous employer.
- A **full** birth or adoption certificate issued in the UK which includes the name(s) of at least one of the holder's parents or adoptive parents, **when produced in combination with** an official document giving the person's permanent National Insurance number and their name issued by a Government agency or a previous employer.
- A birth or adoption certificate issued in the Channel Islands, the Isle of Man or Ireland **when produced in combination with** an official document giving the person's permanent National Insurance number and their name issued by a Government agency or a previous employer.
- A certificate of registration or naturalisation as a British citizen, **when produced in combination with** an official document giving the person's permanent National Insurance number and their name issued by a Government agency or a previous employer.
- A **current** passport endorsed to show that the holder is allowed to stay in the UK and is currently allowed to work and is not subject to a condition preventing the holder from doing work relating to the carrying on of a licensable activity.

**Continued from previous page...**

- A **current** Biometric Immigration Document (Biometric Residence Permit) issued by the Home Office to the holder which indicates that the named person can currently stay in the UK and is allowed to work relation to the carrying on of a licensable activity.
- A **current** Residence Card issued by the Home Office to a person who is not a national of a European Economic Area state or Switzerland but who is a family member of such a national or who has derivative rights or residence.
- A **current** Immigration Status Document containing a photograph issued by the Home Office to the holder with an endorsement indicating that the named person may stay in the UK, and is allowed to work and is not subject to a condition preventing the holder from doing work relating to the carrying on of a licensable activity **when produced in combination with** an official document giving the person's permanent National Insurance number and their name issued by a Government agency or a previous employer.
- A Certificate of Application, **less than 6 months old**, issued by the Home Office under regulation 17(3) or 18A (2) of the Immigration (European Economic Area) Regulations 2006, to a person who is not a national of a European Economic Area state or Switzerland but who is a family member of such a national or who has derivative rights of residence.
- Reasonable evidence that the person has an outstanding application to vary their permission to be in the UK with the Home Office such as the Home Office acknowledgement letter or proof of postage evidence, or reasonable evidence that the person has an appeal or administrative review pending on an immigration decision, such as an appeal or administrative review reference number.
- Reasonable evidence that a person who is not a national of a European Economic Area state or Switzerland but who is a family member of such a national or who has derivative rights of residence in exercising treaty rights in the UK including:-
  - evidence of the applicant's own identity – such as a passport,
  - evidence of their relationship with the European Economic Area family member – e.g. a marriage certificate, civil partnership certificate or birth certificate, and
  - evidence that the European Economic Area national has a right of permanent residence in the UK or is one of the following if they have been in the UK for more than 3 months:
    - (i) working e.g. employment contract, wage slips, letter from the employer,
    - (ii) self-employed e.g. contracts, invoices, or audited accounts with a bank,
    - (iii) studying e.g. letter from the school, college or university and evidence of sufficient funds; or
    - (iv) self-sufficient e.g. bank statements.

Family members of European Economic Area nationals who are studying or financially independent must also provide evidence that the European Economic Area national and any family members hold comprehensive sickness insurance in the UK. This can include a private medical insurance policy, an EHIC card or an S1, S2 or S3 form.

**Original documents must not be sent to licensing authorities.** If the document copied is a passport, a copy of the following pages should be provided:-

- (i) any page containing the holder's personal details including nationality;
- (ii) any page containing the holder's photograph;
- (iii) any page containing the holder's signature;
- (iv) any page containing the date of expiry; and
- (v) any page containing information indicating the holder has permission to enter or remain in the UK and is permitted to work.

If the document is not a passport, a copy of the whole document should be provided.

Your right to work will be checked as part of your licensing application and this could involve us checking your immigration status with the Home Office. We may otherwise share information with the Home Office. Your licence application will not be determined until you have complied with this guidance.

**Section 20 of 21**

**NOTES ON REGULATED ENTERTAINMENT**

**Continued from previous page...**

In terms of specific **regulated entertainments** please note that:

- Plays: no licence is required for performances between 08:00 and 23.00 on any day, provided that the audience does not exceed 500.
- Films: no licence is required for 'not-for-profit' film exhibition held in community premises between 08.00 and 23.00 on any day provided that the audience does not exceed 500 and the organiser (a) gets consent to the screening from a person who is responsible for the premises; and (b) ensures that each such screening abides by age classification ratings.
- Indoor sporting events: no licence is required for performances between 08.00 and 23.00 on any day, provided that the audience does not exceed 1000.
- Boxing or Wrestling Entertainment: no licence is required for a contest, exhibition or display of Greco-Roman wrestling, or freestyle wrestling between 08.00 and 23.00 on any day, provided that the audience does not exceed 1000. Combined fighting sports – defined as a contest, exhibition or display which combines boxing or wrestling with one or more martial arts – are licensable as a boxing or wrestling entertainment rather than an indoor sporting event.
- Live music: no licence permission is required for:
  - o a performance of unamplified live music between 08.00 and 23.00 on any day, on any premises.
  - o a performance of amplified live music between 08.00 and 23.00 on any day on premises authorised to sell alcohol for consumption on those premises, provided that the audience does not exceed 500.
  - o a performance of amplified live music between 08.00 and 23.00 on any day, in a workplace that is not licensed to sell alcohol on those premises, provided that the audience does not exceed 500.
  - o a performance of amplified live music between 08.00 and 23.00 on any day, in a church hall, village hall, community hall, or other similar community premises, that is not licensed by a premises licence to sell alcohol, provided that (a) the audience does not exceed 500, and (b) the organiser gets consent for the performance from a person who is responsible for the premises.
  - o a performance of amplified live music between 08.00 and 23.00 on any day, at the non-residential premises of (i) a local authority, or (ii) a school, or (iii) a hospital, provided that (a) the audience does not exceed 500, and (b) the organiser gets consent for the performance on the relevant premises from: (i) the local authority concerned, or (ii) the school or (iii) the health care provider for the hospital.
- Recorded Music: no licence permission is required for:
  - o any playing of recorded music between 08.00 and 23.00 on any day on premises authorised to sell alcohol for consumption on those premises, provided that the audience does not exceed 500.
  - o any playing of recorded music between 08.00 and 23.00 on any day, in a church hall, village hall, community hall, or other similar community premises, that is not licensed by a premises licence to sell alcohol, provided that (a) the audience does not exceed 500, and (b) the organiser gets consent for the performance from a person who is responsible for the premises.
  - o any playing of recorded music between 08.00 and 23.00 on any day, at the non-residential premises of (i) a local authority, or (ii) a school, or (iii) a hospital, provided that (a) the audience does not exceed 500, and (b) the organiser gets consent for the performance on the relevant premises from: (i) the local authority concerned, or (ii) the school proprietor or (iii) the health care provider for the hospital.

**Continued from previous page...**

- Dance: no licence is required for performances between 08.00 and 23.00 on any day, provided that the audience does not exceed 500. However, a performance which amounts to adult entertainment remains licensable.
- Cross activity exemptions: no licence is required between 08.00 and 23.00 on any day, with no limit on audience size for:
  - o any entertainment taking place on the premises of the local authority where the entertainment is provided by or on behalf of the local authority;
  - o any entertainment taking place on the hospital premises of the health care provider where the entertainment is provided by or on behalf of the health care provider;
  - o any entertainment taking place on the premises of the school where the entertainment is provided by or on behalf of the school proprietor; and
  - o any entertainment (excluding films and a boxing or wrestling entertainment) taking place at a travelling circus, provided that (a) it takes place within a moveable structure that accommodates the audience, and (b) that the travelling circus has not been located on the same site for more than 28 consecutive days.

**Section 21 of 21**

**PAYMENT DETAILS**

This fee must be paid to the authority. If you complete the application online, you must pay it by debit or credit card.

Premises Licence Fees are determined by the non domestic rateable value of the premises.

To find out a premises non domestic rateable value go to the Valuation Office Agency site at [http://www.voa.gov.uk/business\\_rates/index.htm](http://www.voa.gov.uk/business_rates/index.htm)

Band A - No RV to £4300	£100.00
Band B - £4301 to £33000	£190.00
Band C - £33001 to £8700	£315.00
Band D - £87001 to £12500	£450.00*
Band E - £125001 and over	£635.00*

\*If the premises rateable value is in Bands D or E and the premises is primarily used for the consumption of alcohol on the premises then your are required to pay a higher fee

Band D - £87001 to £12500	£900.00
Band E - £125001 and over	£1,905.00

There is an exemption from the payment of fees in relation to the provision of regulated entertainment at church halls, chapel halls or premises of a similar nature, village halls, parish or community halls, or other premises of a similar nature. The costs associated with these licences will be met by central Government. If, however, the licence also authorises the use of the premises for the supply of alcohol or the provision of late night refreshment, a fee will be required.

Schools and sixth form colleges are exempt from the fees associated with the authorisation of regulated entertainment where the entertainment is provided by and at the school or college and for the purposes of the school or college.

If you operate a large event you are subject to ADDITIONAL fees based upon the number in attendance at any one time

Capacity 5000-9999	£1,000.00
Capacity 10000 -14999	£2,000.00
Capacity 15000-19999	£4,000.00
Capacity 20000-29999	£8,000.00
Capacity 30000-39000	£16,000.00
Capacity 40000-49999	£24,000.00
Capacity 50000-59999	£32,000.00
Capacity 60000-69999	£40,000.00
Capacity 70000-79999	£48,000.00

Continued from previous page...

Capacity 80000-89999 £56,000.00  
Capacity 90000 and over £64,000.00

\* Fee amount (£)

## DECLARATION

\* I/we understand it is an offence, liable on conviction to a fine up to level 5 on the standard scale, under section 158 of the licensing act 2003, to make a false statement in or in connection with this application.

Ticking this box indicates you have read and understood the above declaration

This section should be completed by the applicant, unless you answered "Yes" to the question "Are you an agent acting on behalf of the applicant?"

\* Full name

\* Capacity

\* Date  /  /   
dd mm yyyy

Once you're finished you need to do the following:

1. Save this form to your computer by clicking file/save as...
2. Go back to <https://www.gov.uk/apply-for-a-licence/premises-licence/oxford/apply-1> to upload this file and continue with your application.

Don't forget to make sure you have all your supporting documentation to hand.

**IT IS AN OFFENCE LIABLE TO SUMMARY CONVICTION TO A FINE OF ANY AMOUNT UNDER SECTION 158 OF THE LICENSING ACT 2003, TO MAKE A FALSE STATEMENT IN OR IN CONNECTION WITH THIS APPLICATION**

**IT IS AN OFFENCE UNDER SECTION 24B OF THE IMMIGRATION ACT 1971 FOR A PERSON TO WORK WHEN THEY KNOW, OR HAVE REASONABLE CAUSE TO BELIEVE, THAT THEY ARE DISQUALIFIED FROM DOING SO BY REASON OF THEIR IMMIGRATION STATUS. THOSE WHO EMPLOY AN ADULT WITHOUT LEAVE OR WHO IS SUBJECT TO CONDITIONS AS TO EMPLOYMENT WILL BE LIABLE TO A CIVIL PENALTY UNDER SECTION 15 OF THE IMMIGRATION, ASYLUM AND NATIONALITY ACT 2006 AND PURSUANT TO SECTION 21 OF THE SAME ACT, WILL BE COMMITTING AN OFFENCE WHERE THEY DO SO IN THE KNOWLEDGE, OR WITH REASONABLE CAUSE TO BELIEVE, THAT THE EMPLOYEE IS DISQUALIFIED**

**OFFICE USE ONLY**

Applicant reference number	SJL KuPP rooftop restaurant at John Lewis Oxf
Fee paid	
Payment provider reference	
ELMS Payment Reference	
Payment status	
Payment authorisation code	
Payment authorisation date	
Date and time submitted	
Approval deadline	
Error message	
Is Digitally signed	<input type="checkbox"/>

< Previous [1](#) [2](#) [3](#) [4](#) [5](#) [6](#) [7](#) [8](#) [9](#) [10](#) [11](#) [12](#) [13](#) [14](#) [15](#) [16](#) [17](#) [18](#) [19](#) [20](#) [21](#) Next >

PLEASE NOTE: This drawing is based on information furnished to the architect. It is the responsibility of the architect to verify the accuracy of this information. The architect shall not be held responsible for any errors or omissions in this drawing.

### GRAPES DESIGN

PROJECT NO.	100-000000
DATE	10/01/10
SCALE	AS SHOWN
DESIGNER	GRAPES DESIGN
PROJECT NAME	GRAPES DESIGN
PROJECT NO.	100-000000
DATE	10/01/10
SCALE	AS SHOWN
DESIGNER	GRAPES DESIGN

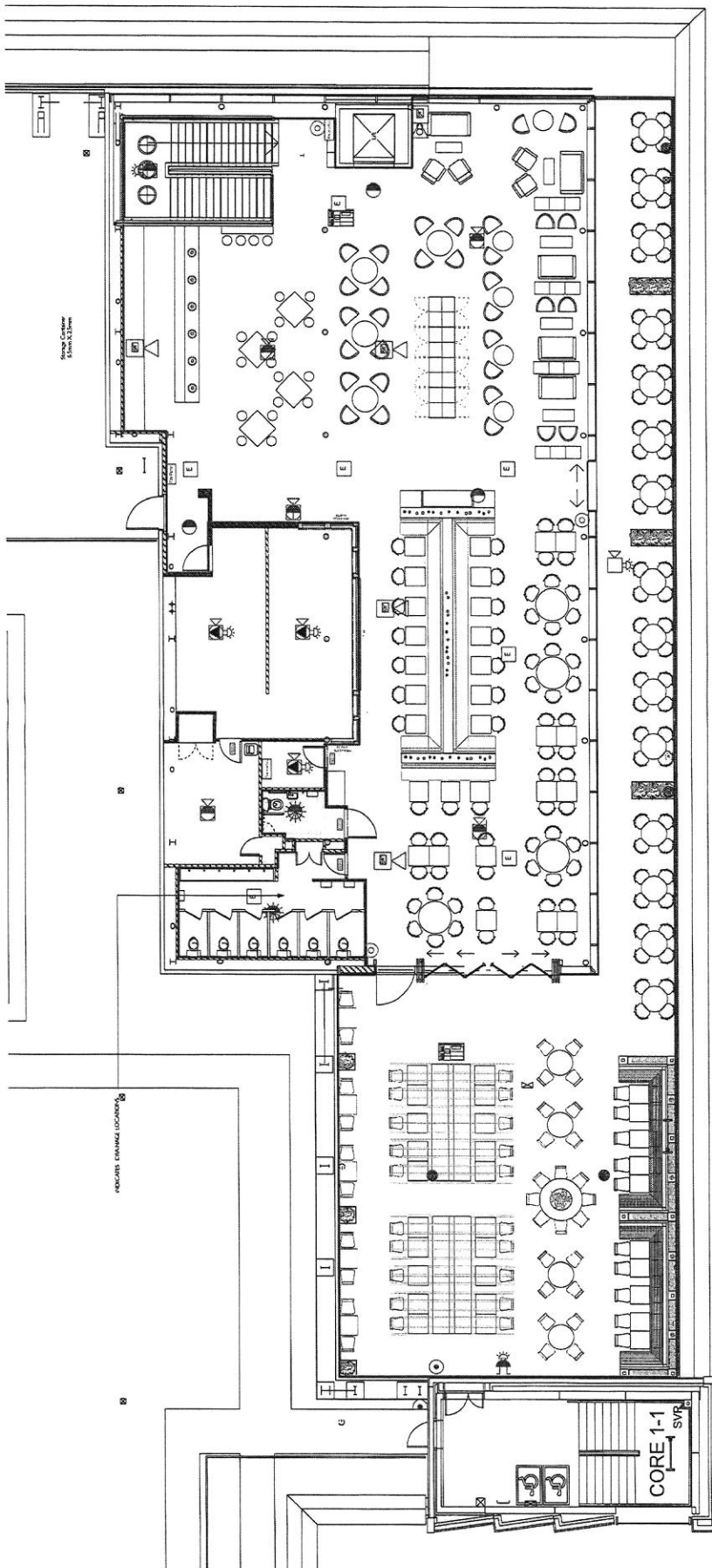

#### LEGEND

- KITCHEN
- DINING AREA
- BAR AREA
- RECEPTION
- CONFERENCE ROOM
- MEETING ROOM
- OFFICE AREA
- RESTROOM
- ELEVATOR
- STAIRCASE
- UTILITY ROOM
- STORAGE ROOM
- JANITOR ROOM
- BREAK ROOM
- STORAGE ROOM
- RESTROOM
- STAIRCASE
- UTILITY ROOM
- STORAGE ROOM

1 LICENSE PLAN



Licensing Authority  
Oxford City Council

26.9.17

I wish to oppose the application to sell alcohol at night in John Lewis's roof-top restaurant by Fancet Inn Ltd. on the following grounds: public nuisance, disorder and public safety.

Those of us who live along Thomas Street opposite the roof-top restaurant, have tried to keep the nights in our area as quiet as possible and with the demise of the Coven Club thought our problems were over. After a couple of alcoholic drinks, most people (including myself) talk more loudly and make poor drivers. 'Slightly' inebriated customers from the restaurant will keep us awake at night one way or another. Their cars will accelerate noisily away from the underground car park and there may be accidents. Thomas street carries fast through traffic including heavy lorries after 2200 hours.

Lastly, this area is to one side of the city centre and is a residential area. Please consider this when deciding whether or not to grant a licence to Fancet <sup>Inn</sup> Ltd

Yours sincerely

The Licensing Authority  
Oxford City Council

KUPP Rooftop Restaurant At John Lewis



Legend

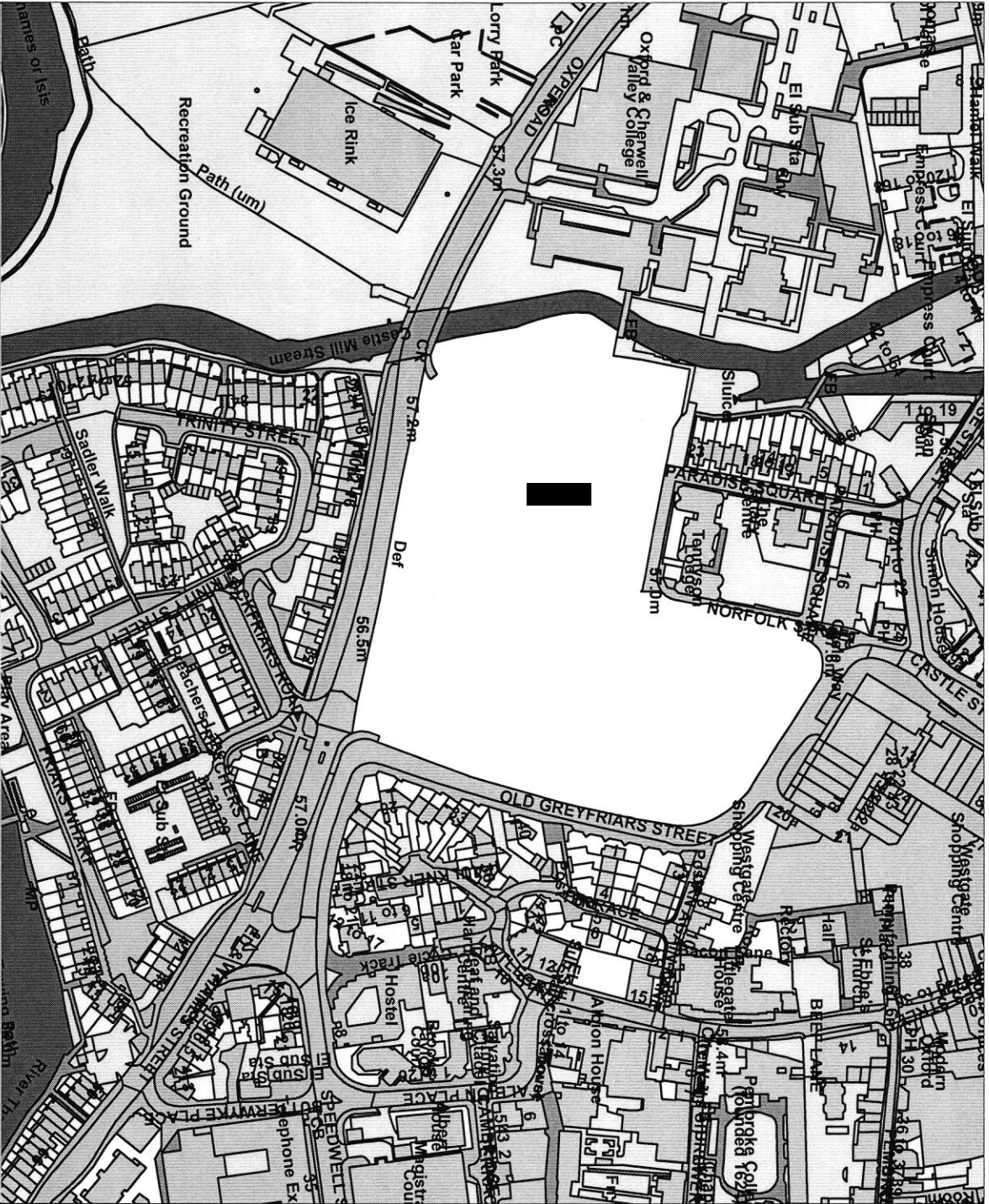

© Crown Copyright and database right 2013. Ordnance Survey 100019348.



Organisation	Oxford City Council
Department	Licensing
Comments	
Date	28 September 2017
SLA Number	100019348

1:2904